

**GAUGE AND PRESS WHEEL SCRAPER MOUNTING INSTRUCTIONS**

**Great Plains Precision Seeding Systems for Narrow and Wide Tires**

(Read Instructions Completely before Beginning Installation)

**Before working on your planter or drill**

**DANGER:** when storing or working on the planter always install cylinder stops or place the planter on stands to prevent personal injury or damage to the attachments.

**Mounting Instructions**

Before you begin, verify the “package contents” to ensure all items are included.

**Step #1:** remove the gauge arm pinch bolt. Assemble tee bar and scraper as shown paying attention that the tee bar bolt (1/2 x 1”) is in the center hole on angle iron. (The hole closer to the edge or off centered hole is for the 1/2 x 3” gauge arm pinch hole). Position assembly as per picture and tighten all bolts.

**Step #2:** be sure to spin tire to set clearance. Also, check for any interference from adjoining rows.

Great Plains Scraper Package Contents (per single row)	
Item	Quantity
1/2 x 3” bolts . . . . .	2
1/2 lock washers . . . . .	4
1/2 x 1” bolts . . . . .	2
1/2 nuts . . . . .	4
1/4 x 1” Carriage Bolts . . . . .	4
1/4 whiz nuts . . . . .	4
large scraper (JD) . . . . .	1
small scraper (square) . . . . .	1
Instruction Sheet . . . . .	1

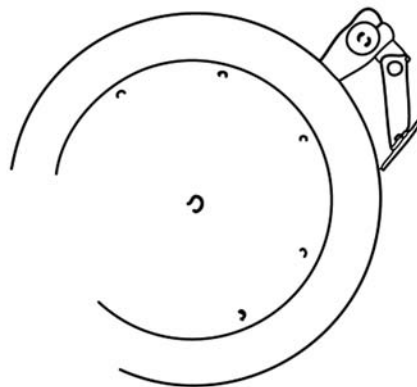
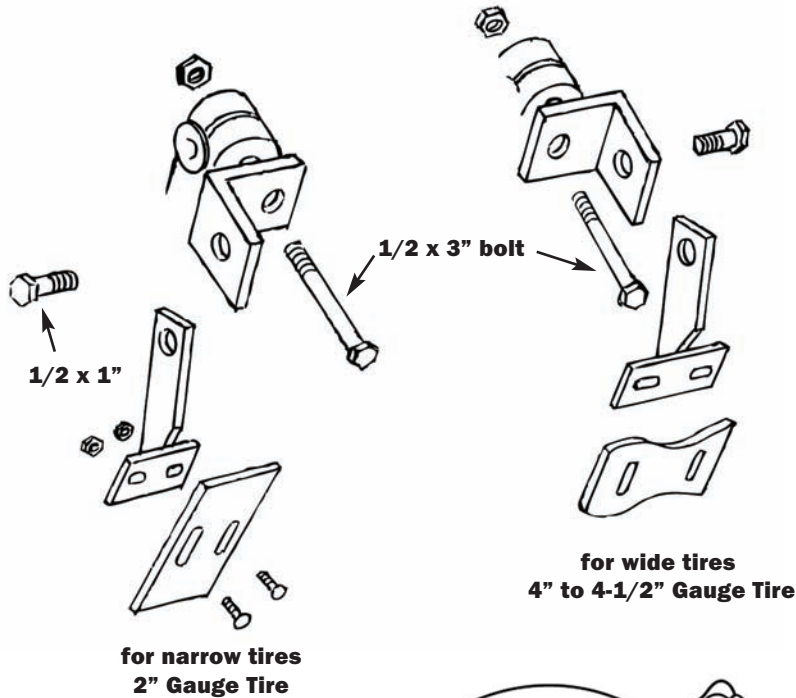

**typical wheel**