

G2™ MOUNTING INSTRUCTIONS

Case IH 2100

Before working on your planter or drill

DANGER: When storing or working on the planter always install cylinder stops or place the planter on stands to prevent personal injury or damage to the attachments.

PLEASE: Read instructions completely and verify all package contents before beginning installation

Installing the Arm Bracket to the Tail Section

1. Remove the press wheel from the tail section of the planter.

2. Use the 3/8" x 1-1/4" carriage bolts to bolt the arms onto your tail section as shown in the photo. The bolt goes through the bottom front hole of the arm from the inside of the tail section (see figure 1). Secure in place with 3/8" lock nut on the outside of the arm.

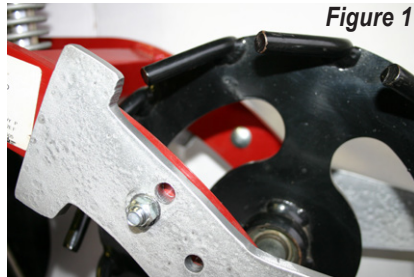

Figure 1

3. Use your original 9" bolt to replace your original or Chicken Tracker press wheel.



Figure 2



Figure 3

4. Bolt the mounting brackets onto the arm using the 3/8" x 1-1/4" bolts. NOTE, there are left & right mounting brackets, the part that the disc bolts onto should be curved in and extend down (see figure 2).

For 9" discs, use the top two holes on the back of the arm.

For 8" discs, use the bottom two holes.

Put the bolts through the top two holes on the mounting bracket from the outside, and secure in place with two lock nuts on the inside of the arm.

5. Slide the fertilizer bracket onto the mounting bracket as shown (see figure 3). We recommend using the center hole; refer to diagram (see figure 4) on the second page for different depths and settings.

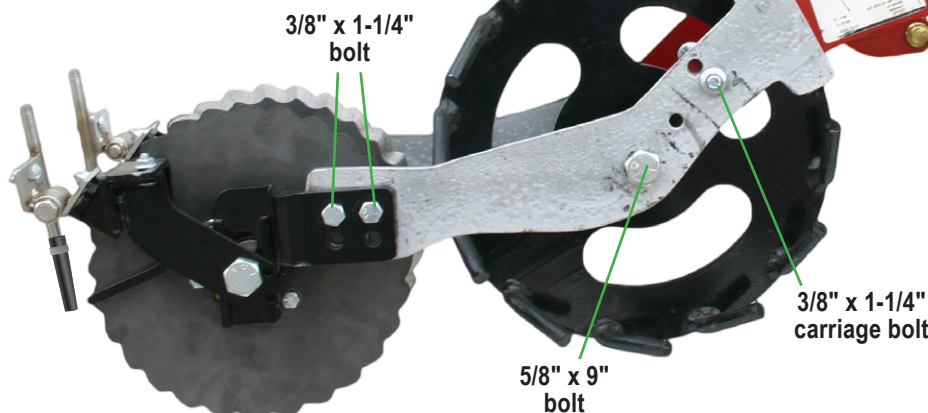

Mounting Bracket Package Contents (per single side)	
Item	Quantity
Arm (Left OR Right)	1
Mounting Bracket (Left OR Right)	1
3/8" x 1-1/4" Bolt	2
3/8" x 1-1/4" Carriage Bolt	1
3/8" Lock Nut	3

G2 Package Contents (per single side)	
Item	Quantity
Bearing, Disc, Hub (Assembly)	1
Fertilizer Bracket	1
Fertilizer Tube Guide	1
Trash Deflector	1
1/2" Spacer	1
5/8" x 3" Bolt	1
5/8" Lock Nut	1
Rubber Boot	1
Hose Clamp	1
Instruction Sheet	1

Pivotable Fertilizer Kit Package Contents (per single side)	
Item	Quantity
G2 FAB Bracket Package	1
Injector Orifice Package	1



OVER →

G2™ MOUNTING INSTRUCTIONS

Case IH 2100

Installing the Fertilizer Bracket & Disc Assembly to the Arm Bracket

9" Disc Depths | 8" Disc Depths Top Holes

Figure 4

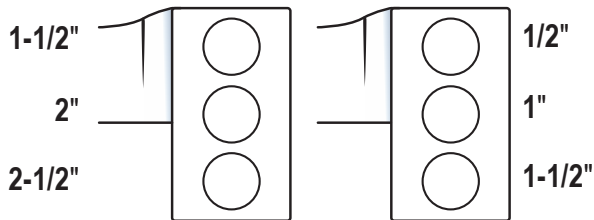

Bottom Holes

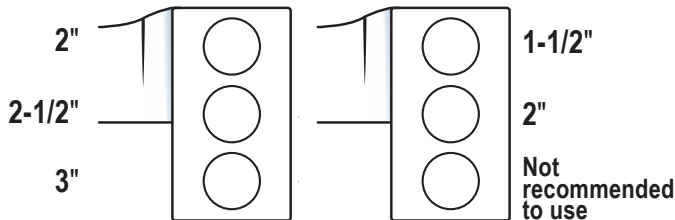

MEASUREMENTS DIAGRAM

Note: All depths described are below soil surface.

Note: All measurements were made with fertilizer bracket arm and fertilizer disc bracket level, based on the settings shown in photo.

Standard spring cylinder may vary if you have hydraulic or air cylinder. It varies based on your down pressure setting.

6. From the outside, slide the 5/8" x 3" bolt through the fertilizer bracket and mounting bracket. Then 1/2" spacer, fertilizer disc with hub away from the spacer, and secure with 5/8" lock nut. If using notched disc, verify that the notches are pointed down in the back.

7. Follow Pivotal Fertilizer Kit instructions for assembling the FAB bracket (see figure 5).

8. Insert injector orifice using an Allen wrench. Slide rubber boot over the fertilizer tube guide and secure in place with hose clamp (see figure 5).

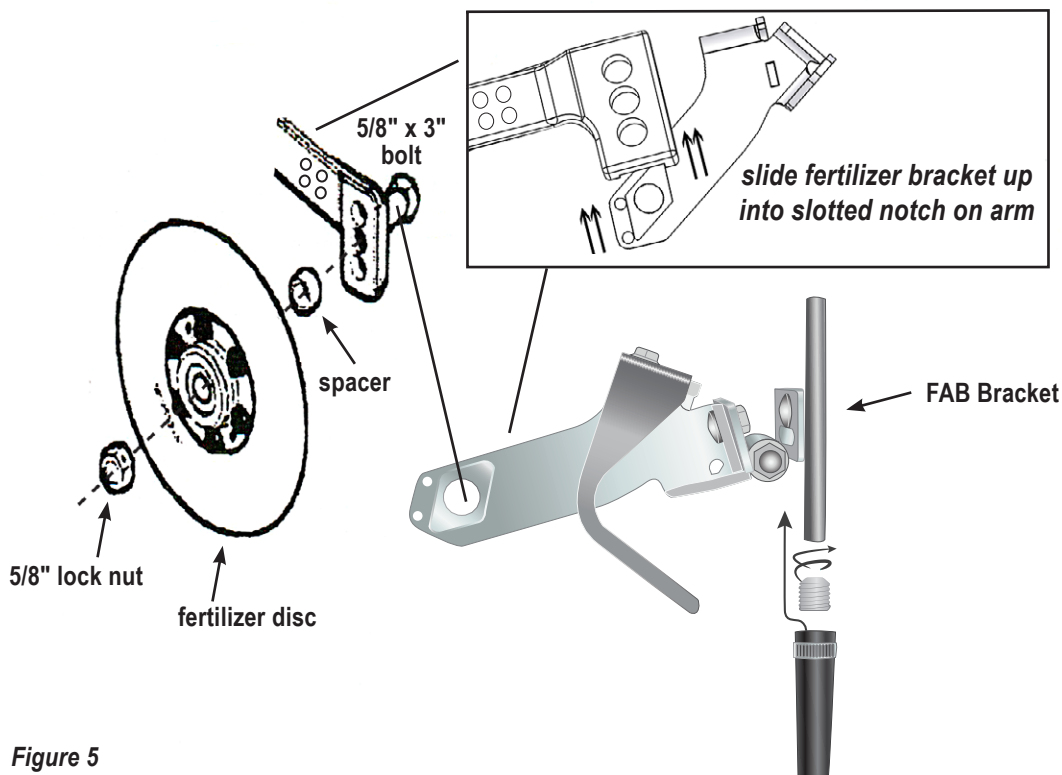

Figure 5