

PUMP SYSTEM MOUNTING INSTRUCTIONS

Electrical Connections

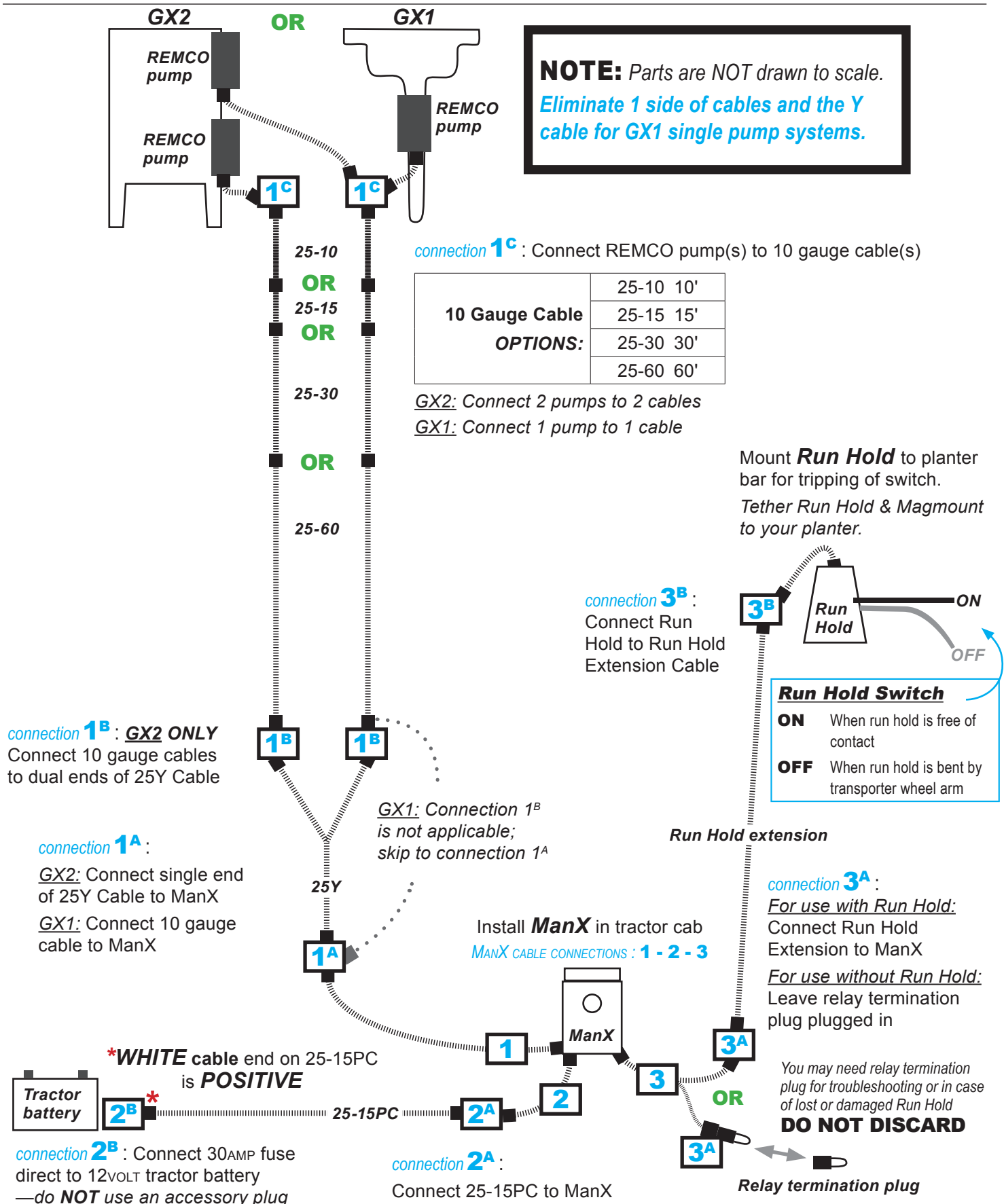

connection 1^B : GX2 ONLY
Connect 10 gauge cables to dual ends of 25Y Cable

connection 1^A :
GX2: Connect single end of 25Y Cable to ManX
GX1: Connect 10 gauge cable to ManX

GX1: Connection 1^B is not applicable; skip to connection 1^A

connection 3^B :
Connect Run Hold to Run Hold Extension Cable

connection 3^A :
For use with Run Hold: Connect Run Hold Extension to ManX
For use without Run Hold: Leave relay termination plug plugged in

***WHITE cable end on 25-15PC is POSITIVE**

connection 2^B : Connect 30AMP fuse direct to 12VOLT tractor battery —do NOT use an accessory plug

connection 2^A :
Connect 25-15PC to ManX

You may need relay termination plug for troubleshooting or in case of lost or damaged Run Hold
DO NOT DISCARD

Relay termination plug

PUMP SYSTEM MOUNTING INSTRUCTIONS

Electrical Connections

NOTE: Parts are NOT shown to scale.
Eliminate 1 side of cables and the Y cable for GX1 single pump systems.

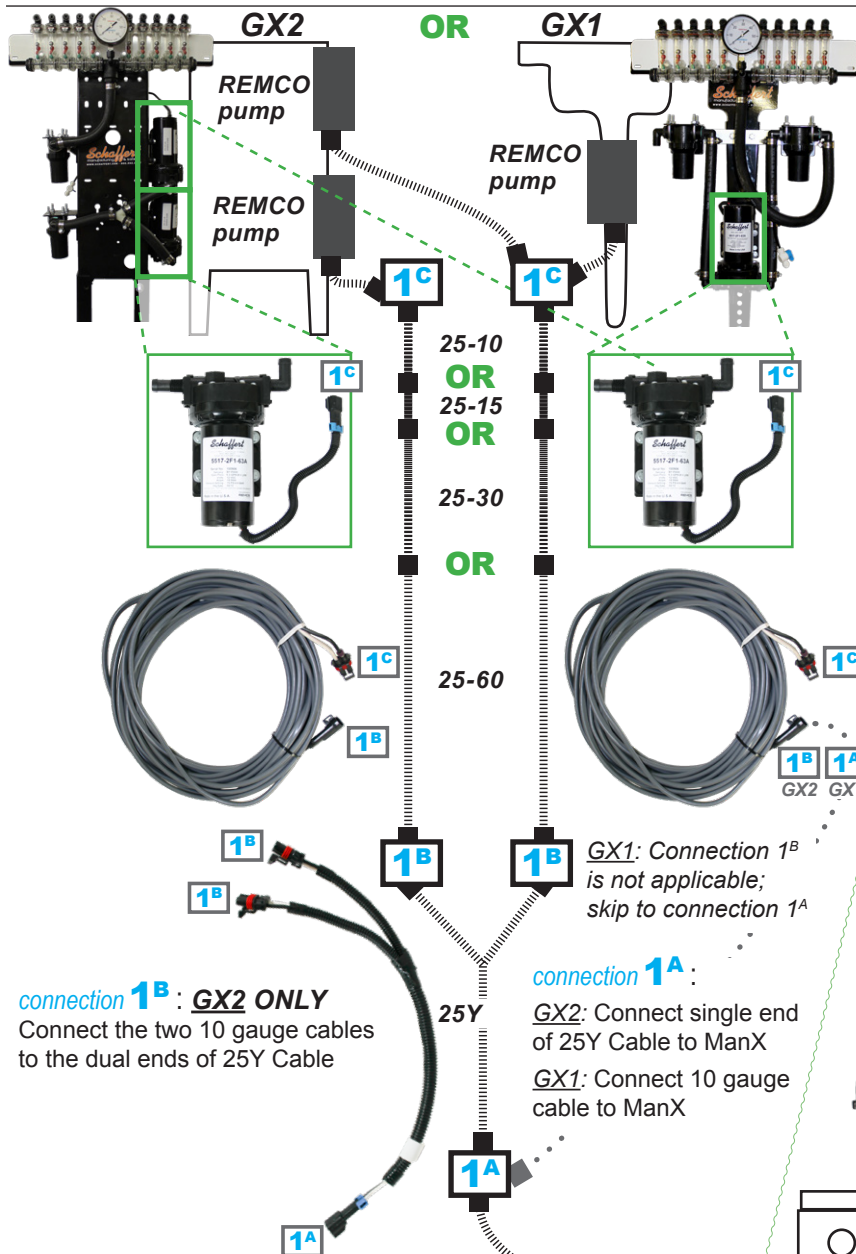

connection 1^C:

Connect REMCO pump(s) to 10 gauge cable(s)

10 Gauge Cable OPTIONS:	25-10 10'
	25-15 15'
	25-30 30'
	25-60 60'

GX2: Connect 2 pumps to 2 cables

GX1: Connect 1 pump to 1 cable

connection 1^B: GX2 ONLY
Connect the two 10 gauge cables to the dual ends of 25Y Cable

connection 1^A:
GX2: Connect single end of 25Y Cable to ManX
GX1: Connect 10 gauge cable to ManX

connection 2^B: Connect 30AMP fuse direct to 12VOLT tractor battery—do NOT use an accessory plug

*WHITE cable end on 25-15PC is POSITIVE

connection 2^A:
Connect 25-15PC to ManX

Install ManX in tractor cab
1 - 2 - 3
CABLE CONNECTIONS

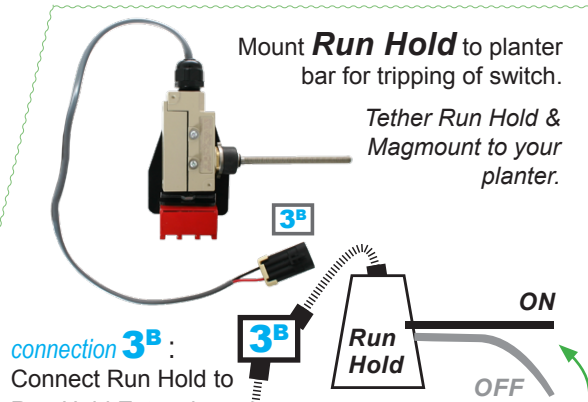

connection 3^B:
Connect Run Hold to Run Hold Extension

Run Hold Switch

- ON** When run hold is free of contact
- OFF** When run hold is bent by transporter wheel arm

Run Hold extension

connection 3^A:
For use with Run Hold:
Connect Run Hold Extension to ManX

For use without Run Hold:
Leave relay termination plug plugged in

Relay termination plug

You may need relay termination plug for troubleshooting or in case of lost or damaged Run Hold
DO NOT DISCARD